

# KGM | GMT

## Locknuts



Type KGM: Standard nut, plastic

### Product Description

Hexagonal locknut with metric threads for attaching components together.

For routing SUB-D, DVI or PROFIBUS connectors in combination with the split cable glands KVT / QVT, special locknuts with cut-outs are required:

**KGM-SUB-D9** fits D-Sub 9 connectors  
(Required wall cut-out: Ø 36 mm)

**KGM-PB** fits DVI and PROFIBUS connectors  
(Required wall cut-out: Ø 42 mm)

**KGM-SUB-D25** fits SUB-D25 connectors  
(Required wall cut-out: Ø 50 mm)

Split hexagonal locknuts GMT for use in combination with split cable glands KVT/QVT whenever pre-terminated cables are routed inside cable protection conduits through a machine or enclosure wall. Suitable for split corrugated conduits CONFIX WST.

| Thread | Type | Order No. | Material | Height [mm] | Wrench size | Diagonal [mm] | Cut-out a×b[mm] | PU |
|--------|------|-----------|----------|-------------|-------------|---------------|-----------------|----|
|--------|------|-----------|----------|-------------|-------------|---------------|-----------------|----|

#### Type KGM: Standard nut, plastic

|                         |        |                    |    |     |         |       |   |    |
|-------------------------|--------|--------------------|----|-----|---------|-------|---|----|
| M16 × 1.5               | KGM 16 | □ 52272            | PA | 4.3 | SW 22.8 | 28.2  | - | 10 |
| M20 × 1.5               | KGM 20 | □ 52273<br>■ 52283 | PA | 7   | SW 26   | 28.2  | - | 10 |
| M25 × 1.5               | KGM 25 | □ 52274<br>■ 52284 | PA | 7   | SW 32   | 36    | - | 10 |
| M32 × 1.5               | KGM 32 | □ 52275<br>■ 52285 | PA | 7   | SW 41   | 46    | - | 10 |
| M40 × 1.5               | KGM 40 | □ 52276<br>■ 52286 | PA | 7   | SW 50   | 56    | - | 10 |
| M50 × 1.5               | KGM 50 | □ 52277<br>■ 52287 | PA | 8.5 | SW 60   | 66    | - | 10 |
| M63 × 1.5               | KGM 63 | □ 52278<br>■ 52288 | PA | 8.5 | SW 75   | 83    | - | 5  |
| <b>NEW</b><br>M75 × 1.5 | KGM 75 | ■ 52289            | PA | 8.5 | SW 85   | 93.1  | - | 5  |
| <b>NEW</b><br>M85 × 2   | KGM 85 | ■ 52290            | PA | 10  | SW 100  | 109.5 | - | 5  |

6



**NEW**

### Wrenches for M75/M85 Plastic Locknuts

For mounting the new KEL-DPF sizes we offer suitable wrenches with widths for M75 and M85 plastic locknuts. Material: aluminum

M75: Order No.61436 | M85: Order No. 61437 | PU: 1

# KGM | GMT Locknuts



Type KGM: SUB-D9, PB, SUB-D25



Type GMT: Split locknut



| Thread | Type | Order No. | Material | Height [mm] | Wrench size | Diagonal [mm] | Cut-out a×b[mm] | PU |
|--------|------|-----------|----------|-------------|-------------|---------------|-----------------|----|
|--------|------|-----------|----------|-------------|-------------|---------------|-----------------|----|

### Type KGM: PB, SUB-D9, SUB-D25

|           |             |  |    |   |       |    |         |    |
|-----------|-------------|--|----|---|-------|----|---------|----|
| M32 × 1.5 | KGM-SUB-D9  | <input type="checkbox"/> 45105<br><input type="checkbox"/> 45106 | PC | 7 | SW 41 | 46 | 35 × 16 | 10 |
| M40 × 1.5 | KGM-PB      | <input type="checkbox"/> 45107<br><input type="checkbox"/> 45109 | PC | 8 | SW 50 | 55 | 43 × 17 | 10 |
| M50 × 1.5 | KGM-SUB-D25 | <input type="checkbox"/> 45108<br><input type="checkbox"/> 45110 | PC | 8 | SW 60 | 66 | 55 × 16 | 10 |

### Type GMT: Split locknut

|           |        |                                |    |    |       |    |   |    |
|-----------|--------|--------------------------------|----|----|-------|----|---|----|
| M20 × 1.5 | GMT 20 | <input type="checkbox"/> 31110 | PA | 9  | SW 27 | 29 | - | 10 |
| M25 × 1.5 | GMT 25 | <input type="checkbox"/> 31100 | PA | 9  | SW 32 | 35 | - | 10 |
| M32 × 1.5 | GMT 32 | <input type="checkbox"/> 31120 | PA | 12 | SW 40 | 44 | - | 10 |
| M50 × 1.5 | GMT 50 | <input type="checkbox"/> 31140 | PA | 15 | SW 63 | 69 | - | 10 |

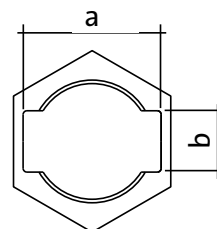

## Specifications

|             |  |
|-------------|--|
| Material    | Polyamide (PA) / Polycarbonate (PC)  |
| Color       | <input type="checkbox"/> gray (similar RAL 7035)<br><input type="checkbox"/> black |
| Flame class | UL94-Vo, self-extinguishing  |
| Temperature | - 30°C to + 120°C  |
| Properties  | Halogen free, silicone free  |

## Compatible with

|                              |         |
|------------------------------|---------|
| KVT, KVT-SNAP, KVT-W90       |         |
| Split cable glands           | 38 - 42 |
| QVT Split cable glands       | 52      |
| KEL-DPZ Cable entry plates   | 70 - 71 |
| KEL-DPF Cable entry grommets | 77      |